

**METRIC SOCKET HEAD CAP SCREWS**

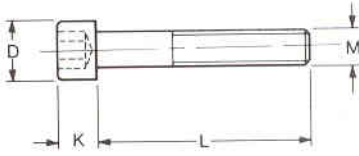

|                            | L                        | CODE      |
|----------------------------|--------------------------|-----------|
| <b>M5</b><br>D=9<br>K=5    | 10                       | 050-05010 |
|                            | 20                       | 050-05020 |
|                            | 30                       | 050-05030 |
|                            | 40                       | 050-05040 |
|                            | 50                       | 050-05050 |
|                            | 60                       | 050-05060 |
|                            | 70                       | 050-05070 |
|                            | <b>M6</b><br>D=10<br>K=6 | 12        |
| 15                         |                          | 050-06015 |
| 20                         |                          | 050-06020 |
| 25                         |                          | 050-06025 |
| 30                         |                          | 050-06030 |
| 40                         |                          | 050-06040 |
| 50                         |                          | 050-06050 |
| 60                         |                          | 050-06060 |
| 70                         |                          | 050-06070 |
| 80                         |                          | 050-06080 |
| 90                         |                          | 050-06090 |
| 100                        |                          | 050-06100 |
| <b>M8</b><br>D=13<br>K=8   | 12                       | 050-08012 |
|                            | 15                       | 050-08015 |
|                            | 20                       | 050-08020 |
|                            | 25                       | 050-08025 |
|                            | 30                       | 050-08030 |
|                            | 35                       | 050-08035 |
|                            | 40                       | 050-08040 |
|                            | 50                       | 050-08050 |
|                            | 60                       | 050-08060 |
|                            | 70                       | 050-08070 |
|                            | 80                       | 050-08080 |
|                            | 90                       | 050-08090 |
| <b>M10</b><br>D=16<br>K=10 | 100                      | 050-08100 |
|                            | 110                      | 050-08110 |
|                            | 120                      | 050-08120 |
|                            | 140                      | 050-08140 |
|                            | 160                      | 050-08160 |
|                            | 20                       | 050-10020 |
|                            | 25                       | 050-10025 |
|                            | 30                       | 050-10030 |
|                            | 35                       | 050-10035 |
|                            | 40                       | 050-10040 |
|                            | 50                       | 050-10050 |
|                            | 60                       | 050-10060 |
| 70                         | 050-10070                |           |
| 80                         | 050-10080                |           |
| 90                         | 050-10090                |           |
| <b>M12</b><br>D=18<br>K=12 | 100                      | 050-10100 |
|                            | 110                      | 050-10110 |
|                            | 120                      | 050-10120 |
|                            | 130                      | 050-10130 |
|                            | 140                      | 050-10140 |
|                            | 160                      | 050-10160 |
|                            | 180                      | 050-10180 |
|                            | 30                       | 050-12030 |
| 40                         | 050-12040                |           |
| 50                         | 050-12050                |           |
| 60                         | 050-12060                |           |
| 70                         | 050-12070                |           |
| 80                         | 050-12080                |           |

continued

**M12**  
D=18  
K=12

|     |           |
|-----|-----------|
| 90  | 050-12090 |
| 100 | 050-12100 |
| 110 | 050-12110 |
| 120 | 050-12120 |
| 130 | 050-12130 |
| 140 | 050-12140 |
| 150 | 050-12150 |
| 160 | 050-12160 |
| 180 | 050-12180 |
| 200 | 050-12200 |
| 40  | 050-16040 |
| 60  | 050-16060 |
| 80  | 050-16080 |
| 100 | 050-16100 |
| 120 | 050-16120 |
| 140 | 050-16140 |
| 160 | 050-16160 |
| 180 | 050-16180 |
| 200 | 050-16200 |
| 250 | 050-16250 |

**M16**  
D=24  
K=16

**METRIC COUNTERSUNK HEAD SOCKET SCREWS**

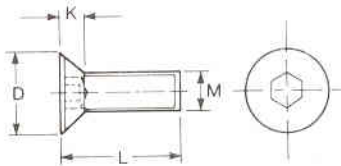

|                               | L  | CODE      |
|-------------------------------|----|-----------|
| <b>M4</b><br>D=8.5<br>K=2.3   | 10 | 048-04010 |
|                               | 12 | 048-04012 |
|                               | 16 | 048-04016 |
|                               | 20 | 048-04020 |
|                               | 25 | 048-04025 |
| <b>M5</b><br>D=10.5<br>K=2.8  | 10 | 048-05010 |
|                               | 12 | 048-05012 |
|                               | 16 | 048-05016 |
|                               | 20 | 048-05020 |
|                               | 25 | 048-05025 |
|                               | 30 | 048-05030 |
| <b>M6</b><br>D=12.5<br>K=3.3  | 12 | 048-06012 |
|                               | 16 | 048-06016 |
|                               | 20 | 048-06020 |
|                               | 25 | 048-06025 |
|                               | 30 | 048-06030 |
|                               | 35 | 048-06035 |
|                               | 40 | 048-06040 |
| <b>M8</b><br>D=16.5<br>K=4.4  | 16 | 048-08016 |
|                               | 20 | 048-08020 |
|                               | 25 | 048-08025 |
|                               | 30 | 048-08030 |
|                               | 35 | 048-08035 |
|                               | 40 | 048-08040 |
|                               | 45 | 048-08045 |
|                               | 50 | 048-08050 |
| <b>M10</b><br>D=21.0<br>K=5.5 | 20 | 048-10020 |
|                               | 25 | 048-10025 |
|                               | 30 | 048-10030 |
|                               | 35 | 048-10035 |
|                               | 40 | 048-10040 |
|                               | 45 | 048-10045 |
|                               | 50 | 048-10050 |

**METRIC SOCKET HEAD SHOULDER SCREWS**

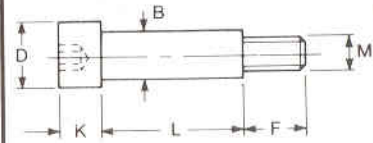

|   | L   | CODE      |
|---|---|-----------|
| <b>M5</b><br>B=6<br>D=10<br>K=4.5<br>F=9.75   | 12  | 047-06012 |
|   | 16  | 047-06016 |
|   | 20  | 047-06020 |
|   | 25  | 047-06025 |
|   | 30  | 047-06030 |
| <b>M6</b><br>B=8<br>D=13<br>K=5.5<br>F=11.25  | 40  | 047-06040 |
|   | 12  | 047-08012 |
|   | 16  | 047-08016 |
|   | 20  | 047-08020 |
|   | 25  | 047-08025 |
|   | 30  | 047-08030 |
| <b>M8</b><br>B=10<br>D=16<br>K=7<br>F=13.25   | 40  | 047-08040 |
|   | 50  | 047-08050 |
|   | 16  | 047-10016 |
|   | 20  | 047-10020 |
|   | 25  | 047-10025 |
|   | 30  | 047-10030 |
|   | 40  | 047-10040 |
|   | 50  | 047-10050 |
|   | 60  | 047-10060 |
|   | 70  | 047-10070 |
|   | 80  | 047-10080 |
|   | 90  | 047-10090 |
| <b>M10</b><br>B=12<br>D=18<br>K=8<br>F=16.25  | 100   | 047-10100 |
|   | 16  | 047-12016 |
|   | 20  | 047-12020 |
|   | 25  | 047-12025 |
|   | 30  | 047-12030 |
|   | 40  | 047-12040 |
|   | 50  | 047-12050 |
|   | 60  | 047-12060 |
|   | 70  | 047-12070 |
|   | 80  | 047-12080 |
| <b>M12</b><br>B=16<br>D=24<br>K=10<br>F=18.25 | 90  | 047-12090 |
|   | 100   | 047-12100 |
|   | 30  | 047-16030 |
|   | 40  | 047-16040 |
|   | 50  | 047-16050 |
|   | 60  | 047-16060 |
|   | 70  | 047-16070 |
|   | 80  | 047-16080 |
|   | 90  | 047-16090 |
|   | 100   | 047-16100 |
| <b>M16</b><br>B=20<br>D=30<br>K=14<br>F=22.25 | 120   | 047-16120 |
|   | 40  | 047-20040 |
|   | 50  | 047-20050 |
|   | 60  | 047-20060 |
|   | 70  | 047-20070 |
|   | 80  | 047-20080 |
|   | 90  | 047-20090 |
|   | 100   | 047-20100 |
|   | 120   | 047-20120 |
|   | <b>M20</b><br>B=24<br>D=36<br>K=16<br>F=27.25 | 50        |
| 60  |   | 047-24060 |
| 70  |   | 047-24070 |
| 80  |   | 047-24080 |
| 90  |   | 047-24090 |
| 100   |   | 047-24100 |
| 120   | 047-24120                                     |           |

**SPRING LOADED BALL RETAINER**

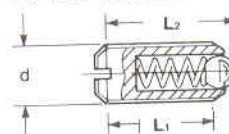

| d   | L1 | L2   | CODE   |
|-----|----|------|--------|
| M6  | 13 | 15.0 | 049 06 |
| M8  | 14 | 16.5 | 049 08 |
| M10 | 15 | 20.0 | 049 10 |
| M12 | 18 | 23.5 | 049 12 |
| M16 | 20 | 27.0 | 049 16 |

Metric socket head shoulder screws are suitable for use with several types of Die Springs — see Spring section.

**ORDERING:** State quantity and code no.

# SHANKS

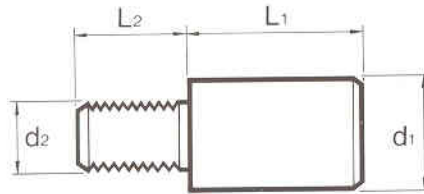

STANDARD SHANKS (IMPERIAL)

| PART No. | d1     | L1     | d2 Thread | L2*    |
|----------|--------|--------|-----------|--------|
| 8-1606-1 | 1"     | 1 1/2" | 3/4"BSF   | 1 1/2" |
| 79111    | 1"     | 1 1/2" | 3/4"BSW   | 1 1/2" |
| 79130    | 1"     | 2"     | 3/4"BSW   | 2"     |
| 8-2408-1 | 1 1/2" | 2"     | 1"BSF     | 2"     |
| 79159    | 1 1/2" | 2"     | 3/4"BSW   | 2"     |
| 8-2808-1 | 1 3/4" | 2"     | 1 1/4"BSF | 2 1/4" |
| 8-3208-1 | 2"     | 2"     | 1 1/4"BSF | 2 1/4" |
| 79295    | 2"     | 2"     | 1"BSW     | 2"     |
| 8-3208-2 | 2"     | 2"     | 1 1/4"BSW | 2 1/4" |
| 8-3208-3 | 2"     | 2"     | M30X2     | 2 1/4" |
| 8-3210-1 | 2"     | 2 1/2" | 1 1/4"BSF | 2 1/4" |
| 79400    | 2"     | 2 1/2" | 1"BSW     | 2"     |
| 8-3210-3 | 2"     | 2 1/2" | M30X2     | 2 1/4" |
| 8-4010-1 | 2 1/2" | 2 1/2" | 1 1/4"BSF | 2 1/4" |
| 79409    | 2 1/2" | 2 1/2" | 1 1/4"BSW | 2 1/4" |
| 8-4010-3 | 2 1/2" | 2 1/2" | M30X2     | 2 1/4" |
| 79434    | 2 1/2" | 3"     | 1 1/4"BSW | 2 1/4" |
| 8-4812-1 | 3"     | 3"     | 1 1/4"BSF | 2 1/4" |
| 79452    | 3"     | 3"     | 1 1/4"BSW | 2 1/4" |

STANDARD SHANKS (METRIC)

| PART No. | d1 | L1 | d2        | L2* |
|----------|----|----|-----------|-----|
| 79476    | 25 | 45 | M20 x 1.5 | 35  |
| 79488    | 32 | 56 | M20 x 1.5 | 35  |
| 79520    | 40 | 70 | M24 x 2.0 | 45  |
| 79543    | 50 | 70 | M24 x 2.0 | 45  |
| 79527    | 40 | 70 | M30 x 2.0 | 60  |
| 79561    | 50 | 80 | M30 x 2.0 | 60  |
| 79573    | 65 | 90 | M30 x 2.0 | 60  |

When ordered as part of a die set, state part number, or body diameter (d<sub>1</sub>) and body length (L<sub>1</sub>). \* L<sub>2</sub> customer to cut to length required.

# LUBRICATORS

The Danly Lubricator consists of a container, which is a press fit on the outside of the bush. A wick is accommodated in the lower portion of the container. These are for fitment to Standard Bushes 'B' only see page 4/7.



| PART No. | PILLAR DIA. | WICK DIA. | PART No. | PILLAR DIA. | WICK DIA. |
|----------|-------------|-----------|----------|-------------|-----------|
| LB 16    | 16          | 5         | LB 32    | 32          | 6         |
| LB 18    | 18          | 5         |          |             |           |
| LB 19    | 19          | 5         |          |             |           |
| LB 24    | 24          | 5         | LB 40    | 40          | 6         |
| LB 25    | 25          | 5         | LB 42    | 42          | 6         |
| LB 30    | 30          | 6         | LB 50    | 50          | 8         |
|          |             |           | LB 52    | 52          | 8         |



# STOCK PUSHER

The Danly Stock Pusher aligns stock against die gauge and holds securely to eliminate problems of shifting stock and consequent waste, downtime and damaged dies.

The wedge unit of the stock pusher is mounted to the punch holder; the roller unit to the die base. In operation, the wedge unit engages the roller unit as the die closes, moving roller unit arm against stripper slide. This, in turn, pushes stock against die gauge and holds securely.

Adjustment of pressure is easily made by turning nuts to alter spring tension — or by replacing spring with a Danly die spring of desired pressure. By adjusting spring load, pressure to suit weight of stock is easily achieved.

The Danly stock pusher is available in two sizes and both are boxed with three different wedge lengths for easy selection of wedge length best suited to the shut-height.

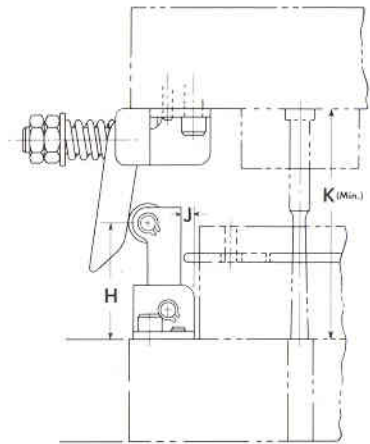
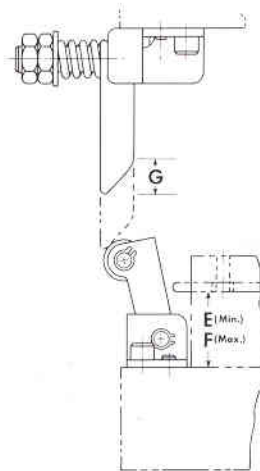
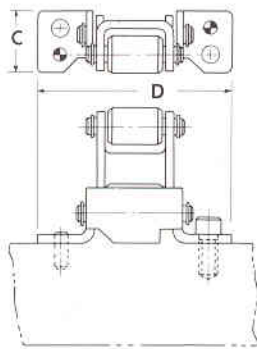
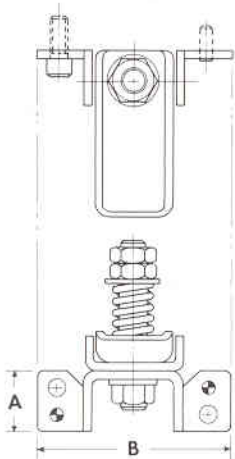
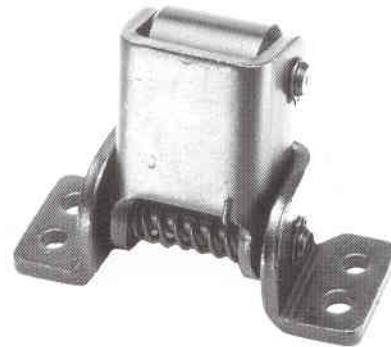

### STOCK PUSHER DIMENSIONS IN MM

| CATALOGUE NUMBER | A  | B  | C  | D  | E (Min.) | F (Max.) | G  | H  | J | K (Min.) | WEDGE LENGTHS |
|------------------|----|----|----|----|----------|----------|----|----|---|----------|---------------|
| 9-90-7           | 22 | 71 | 22 | 71 | 22       | 44       | 16 | 43 | 3 | 76       | 60;73;86      |
| 9-95-7           | 35 | 86 | 32 | 86 | 32       | 57       | 29 | 51 | 5 | 101      | 97;110;122    |

### DIMENSIONS IN INCHES

|        |       |         |       |         |       |       |       |         |      |   |                          |
|--------|-------|---------|-------|---------|-------|-------|-------|---------|------|---|--------------------------|
| 9-90-7 | 7/8   | 2 13/16 | 7/8   | 2 13/16 | 7/8   | 1 3/4 | 5/8   | 1 11/16 | 1/8  | 3 | 2 3/8, 27/8, 3 3/8       |
| 9-95-7 | 1 3/8 | 3 3/8   | 1 1/4 | 3 3/8   | 1 1/4 | 2 1/4 | 1 1/8 | 2       | 3/16 | 4 | 3 13/16, 4 5/16, 4 13/16 |

# DIE SET LUBRICANT & PRY BAR

Danly Oil Lubricant has the proper viscosity and other qualities needed to make it ideal for die set lubrication. One oiling with Danly lubricant will normally last through a day's production run, but re-oiling may be required at longer or shorter intervals as required.



## OIL LUBRICANT

Catalogue No. 6-11-52 ..... 1 litre

Catalogue No. 6-15-52 ..... 5 litres

## PRY BAR

Catalogue No. 9-04-15 ..... As shown

Catalogue No. 9-01-15 ..... without tip and shoe



## SPARE PARTS

Catalogue No. 9-05-15 .....

2 tips, 2 shoes, and necessary screws and nuts

Catalogue No. 9-06-15 .....

6 tips and necessary screws and nuts

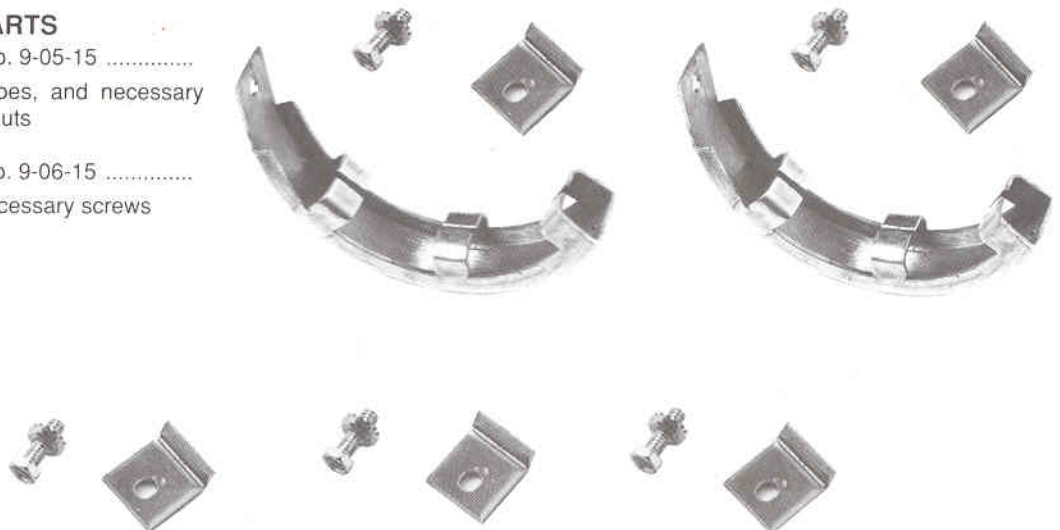

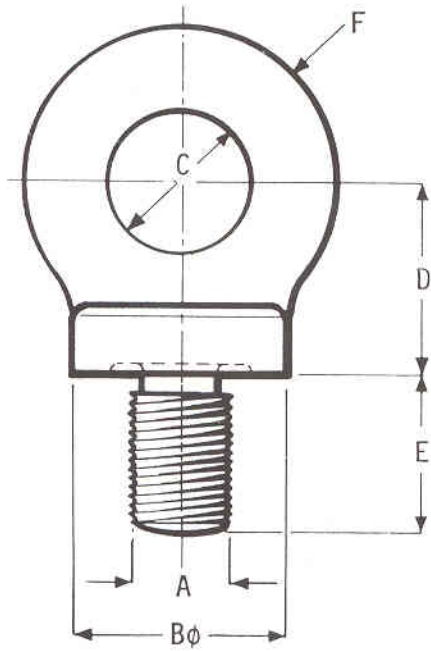

| CODE | LB24 | LB30 |
|------|------|------|
| A    | M24  | M30  |
| B    | 52   | 65   |
| C    | 35   | 44   |
| D    | 46   | 58   |
| E    | 40   | 51   |
| F    | 21   | 26   |
|      | 2.0  | 3.2  |

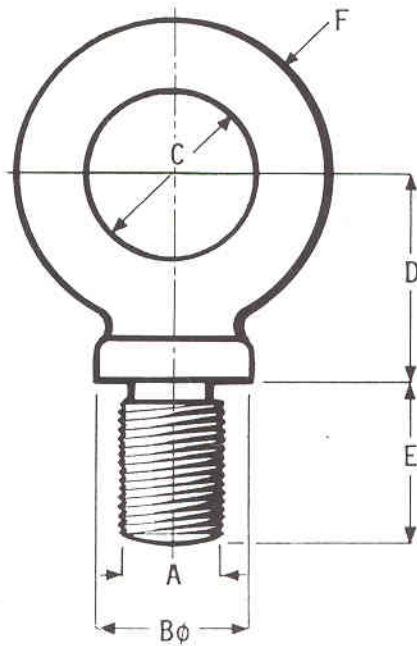

| CODE | LBD12 | LBD16 | LBD20 | LBD24 | LBD30 |
|------|-------|-------|-------|-------|-------|
| A    | M12   | M16   | M20   | M24   | M30   |
| B    | 17    | 23    | 32    | 40    | 51    |
| C    | 22    | 29    | 40    | 51    | 64    |
| D    | 27    | 34    | 47    | 60    | 76    |
| E    | 18    | 23    | 32    | 40    | 51    |
| F    | 9     | 11    | 15    | 19    | 24    |
|      | 0.32  | 0.63  | 1.25  | 2.00  | 3.20  |